

# GROWATT OFF GRID INVERTER

This is a multifunctional off grid solar inverter, integrated with a MPPT solar charge controller. This inverter can work with or without batteries. The whole system also need other devices to achieve complete running such as PV modules, generator, or utility grid. Please consult with your system integrator for other possible system architectures depending on your requirements.



## Growatt SPF3500-5000 ES

### Product Overview

- |                                 |                                  |
|---------------------------------|----------------------------------|
| 1. LCD display                  | 9. BMS/RS485 communication port  |
| 2. Status indicator             | 10. Dry contact                  |
| 3. Charging indicator           | 11. PV input                     |
| 4. Fault indicator              | 12. Input breaker                |
| 5. Function buttons             | 13. AC output                    |
| 6. AC input                     | 14. Current sharing ports        |
| 7. WiFi/GPRS communication port | 15. Parallel communication ports |
| 8. USB communication port       | 16. Battery input                |
|                                 | 17. Power on/off switch          |

### Main Features

#### High Yields

- DC/AC ratio up to 1.2
- 2 times peak power ability
- Output power factor up to 1.0

#### Scalable & Flexible

- Up to 6 units in parallel for capacity extension
- Multi-customized modes for diverse scenarios
- Compatible with lithium and lead-acid battery

#### Smart & Reliable

- Support WiFi and GPRS remote monitoring
- PVkeeper platform for local commissioning
- Timing charging and output control

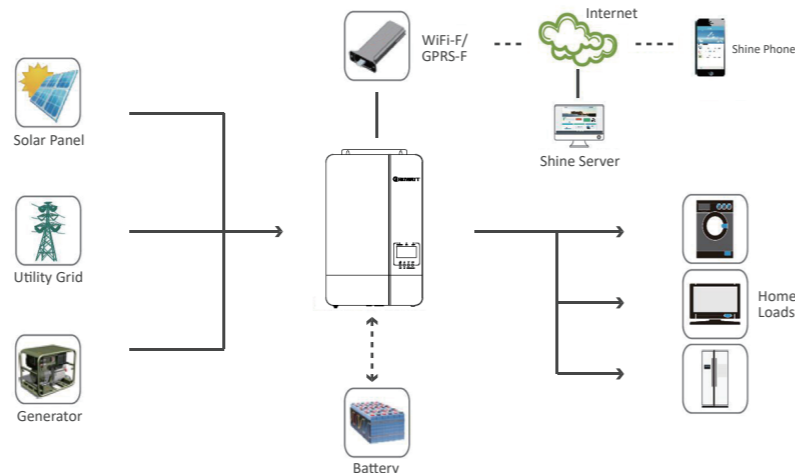
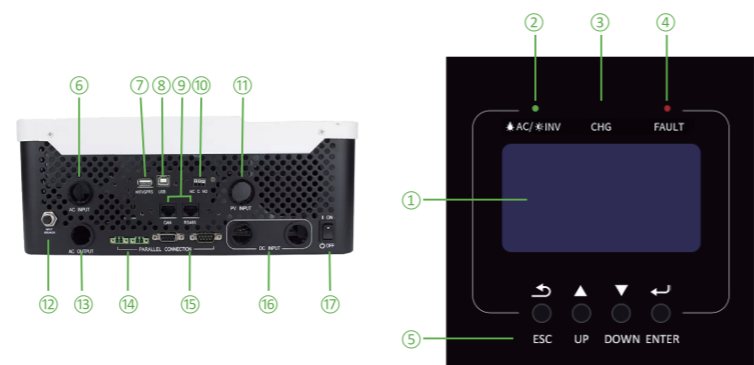

Datasheet	SPF 3500 ES	SPF 5000 ES
Battery Voltage	48VDC	
Battery Type	Lithium/Lead-acid	
<b>INVERTER OUTPUT</b>		
Rated Power	3500VA/3500W	5000VA/5000W
Parallel Capability	Yes,6 units maximum	
AC Voltage Regulation (Battery Mode)	230VAC±5%@50/60Hz	
Surge Power	7000VA	10000VA
Efficiency (Peak)	93%	
Waveform	Pure sine wave	
Transfer Time	10ms typical.20ms Max	
<b>SOLAR CHARGER</b>		
Maximum PV Array Power	4500W	6000W
MPPT Range @ Operating Voltage	120VDC~430VDC	
Number of Independent MPP Trackers/ Strings Per MPP Tracker	1/1	
Maximum PV Array Open Circuit Voltage	450VDC	
Maximum Solar Charge Current	80A	100A
<b>AC CHARGER</b>		
Charge Current	60A	80A
AC Input Voltage	230 VAC	
Selectable Voltage Range	170-280 VAC(For Personal Computers):90-280 VAC(For Home Appliances)	
Frequency Range	50Hz/60Hz(Auto sensing)	
<b>PHYSICAL</b>		
Protection Degree	IP20	
Dimension (W/H/D)	330/485/135mm	
Net Weight	11.5kgs	12kgs
<b>OPERATING ENVIRONMENT</b>		
Humidity	5% to 95% Relative Humidity(Non-condensing)	
Altitude	<2000m	
Operating Temperature	0°C-55°C	
Storage Temperature	-15°C-60°C	